

For a complete, detailed list of the contents of each package, please refer to our website at www.ecocottages.com.

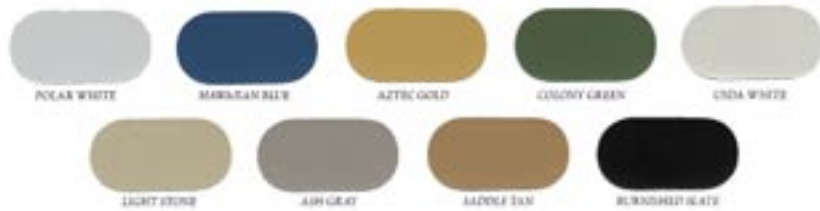

Full kitchen and bath cabinet packages available online.

Dura-20® Colors



Textured Finish® Colors



Color shown may vary slightly from the actual color. Please call UPS for a metal color chip to verify color selection.



ROOF



WALL



FLOOR



Clearspan bright, open rooms.

**Customize
YOUR Cottage
Online Now!**



www.ecocottages.com

Instant Cottage Homes & Storm Shelters
Self-Sufficient Dwelling Units or Backyard Room Additions



Our EcoCottages will help to protect your family from extreme weather, fire & toxic mold hazards.
Engineered for 145mph Winds • 100% Maintenance Free!
Fully Insulated Prefab Kit! • 20 Year Written Warranty!
Integrated "Off-Grid" Energy and Water Storage Options.

EcoCottages, Inc

www.ECOCOTTAGES.com

Northern Steel International (www.nsteel.com)

Phone: 800.916.2044 • Fax: 302.644.3444 • Local Phone: 302.644.0444

Northern Steel Business Center • 34382 Carpenters Way • Lewes, DE 19958

About

EcoCottages offers the world's finest prefabricated, panelized cottage kits. All of our Building Systems are pre-drilled and pre-marked. First-time kit builders can assemble these packages with readily available equipment and tools. Our Insulated Steel Panel Systems and Steel Structure will ensure decades of maintenance free, energy efficient, comfort and safety.

Simply bolt together the prefab frame to a concrete slab or the optional steel subfloor. The next step is to attach the windows and doors. Finish the exterior by simply attaching the prefinished roof and wall sheets along with included trim.

Prefab EcoCottage Kits Assemble In Days

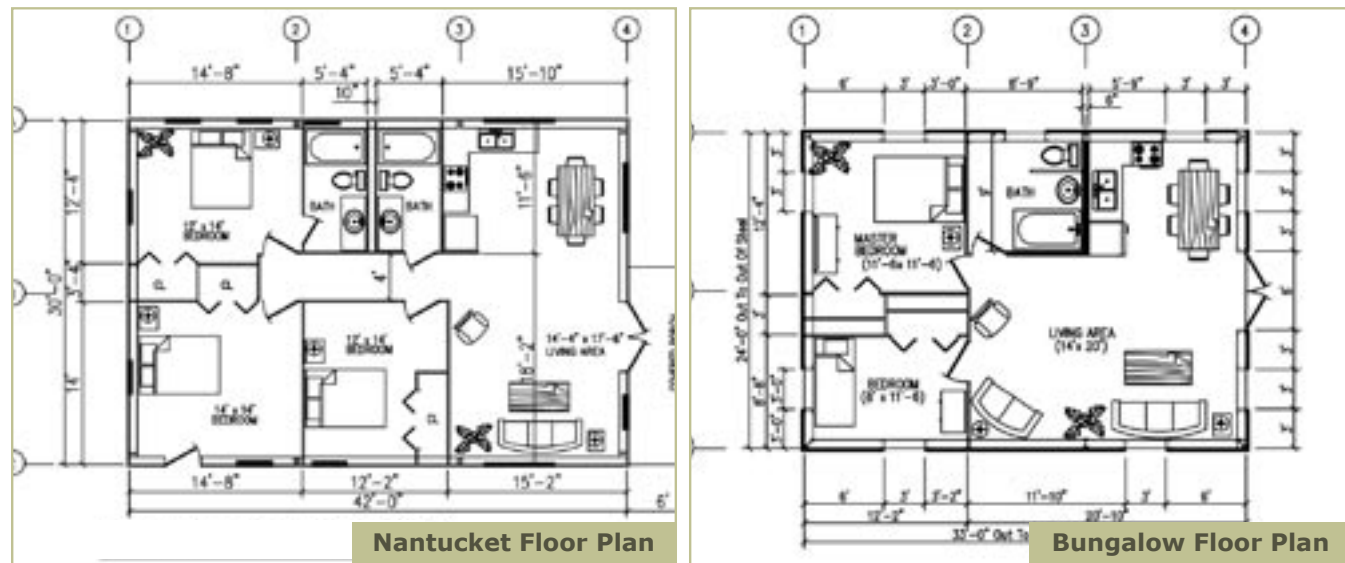

Assembly Sequence

Pre-insulated Exterior Roof & Wall Panels

The RWP Panel functions well as a roof or wall panel when used in conjunction with pre-engineered building framing systems.

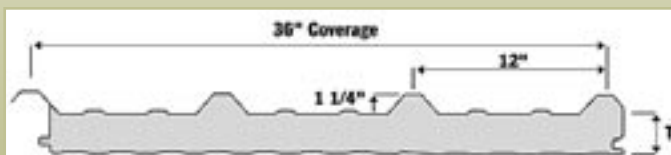
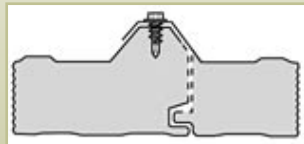

Why Steel?

- EcoCottages can reduce insurance costs.
- Inorganic does not rot, mold, warp, split.
- Termite Proof. Extreme fire and wind resistant.
- Consistent Quality: The EcoCottage Steel is produced in strict accordance with national MBMA specifications.
- Steel has a very high strength to weight ratio.

Available Models & Options



Nantucket Cottage

Dimensions:
30 x 42 x 10
Square Feet:
1260

Our largest, most economical family dwelling unit.

145 mph wind rated.



Kitchenette Unit



AC/Heat/Dehumidifier



Off Grid Toilet



Storm Panel



Solar Energy System



Water Harvesting



Island Bungalow

Dimensions:
24 x 33 x 10
Square Feet:
792

The Island Bungalow is our most popular model.

145 mph wind rated.



Craftsman Cottage

Dimensions:
12 x 15 x 8
Square Feet:
198

Designed as a luxury home office or guest house addition.

145 mph wind rated.



Cabana

Dimensions:
9 x 12 x 8
Square Feet:
108

Our most economical & easy to build model installs in one day. Perfect guest room, studio or home office.

145 mph wind rated.